

4

3

2

1

REVISIONS				
ZONE	LTR	DESCRIPTION	DATE	APPROVED
-	N/C	INITIAL RELEASE, ECN#T-4209	7-13-83	YB

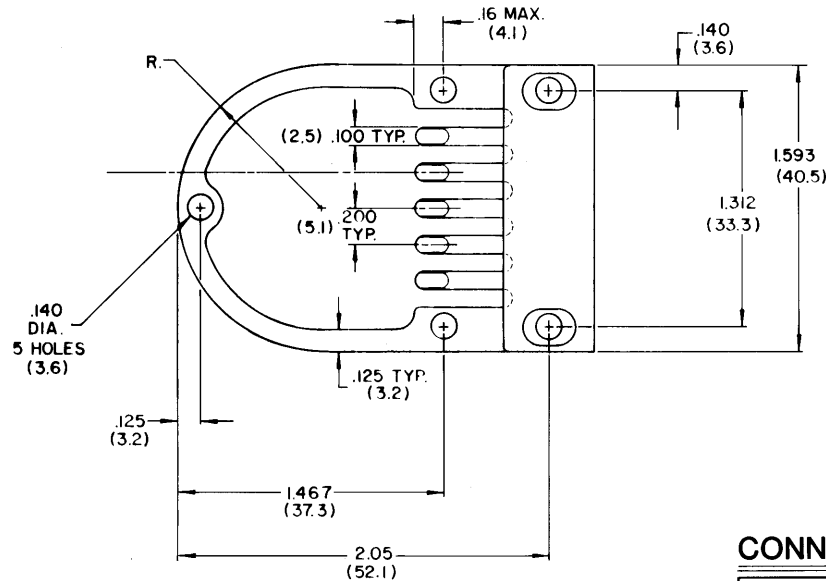
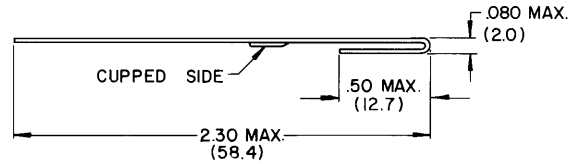

NOTES:

1. TERMINATING BUSS MATERIAL:
.020 COPPER ALLOY TIN PLATED.
2. BUSS TABS ARE DESIGNED TO TERMINATE THE FOLLOWING SHIELDED CABLE CONSTRUCTIONS:
88BIII, 20 THRU 26 AWG
88BII2, 20 THRU 26 AWG
88BII3, 20 THRU 26 AWG
88BII4, 20 THRU 26 AWG

© Raychem Corporation 1983

CONNECTOR SPECIFICATION CONTROL DRAWING

UNLESS OTHERWISE SPECIFIED DIMENSIONS ARE IN INCHES BRACKETED DIMENSIONS () ARE METRIC AND TOLERANCES ARE: .xxx: ± .010 .xx: ± .03 Δ: ±	DRAWN	PIERCE	6-83	Raychem <small>RAYCHEM CORPORATION 300 CONCORD AVENUE MENLO PARK, CALIFORNIA 94025</small>		
	CHECKED	<i>[Signature]</i>	6-23-83			TITLE
	APPROVED	<i>[Signature]</i>	7-13-83	SHIELD, EMI BACKSHELL		
	APPROVED	<i>[Signature]</i>	1-19-83			
				SIZE	CODE IDENT	DWG. NO.
				C	NO. 06090	D-659-0088
				WEIGHT	SHEET	OF

If this document is printed it becomes uncontrolled.
Check with the web for latest revision.

DO NOT SCALE THIS DRAWING